

HONEYWELL PART NUMBER
21SX39-T2
PRODUCT CODE VDM3905
JG-NUMBER JG-80957
MILITARY PART NUMBER 24547-4

REV	DOCUMENT	CHANGED BY	CHECK
12	0038449	VS 28APR08	BLR

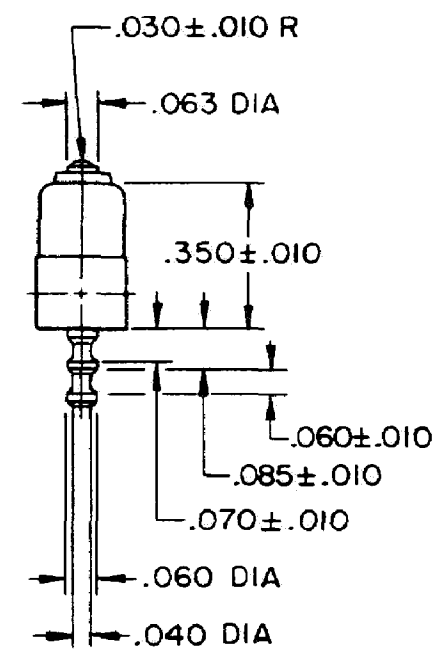
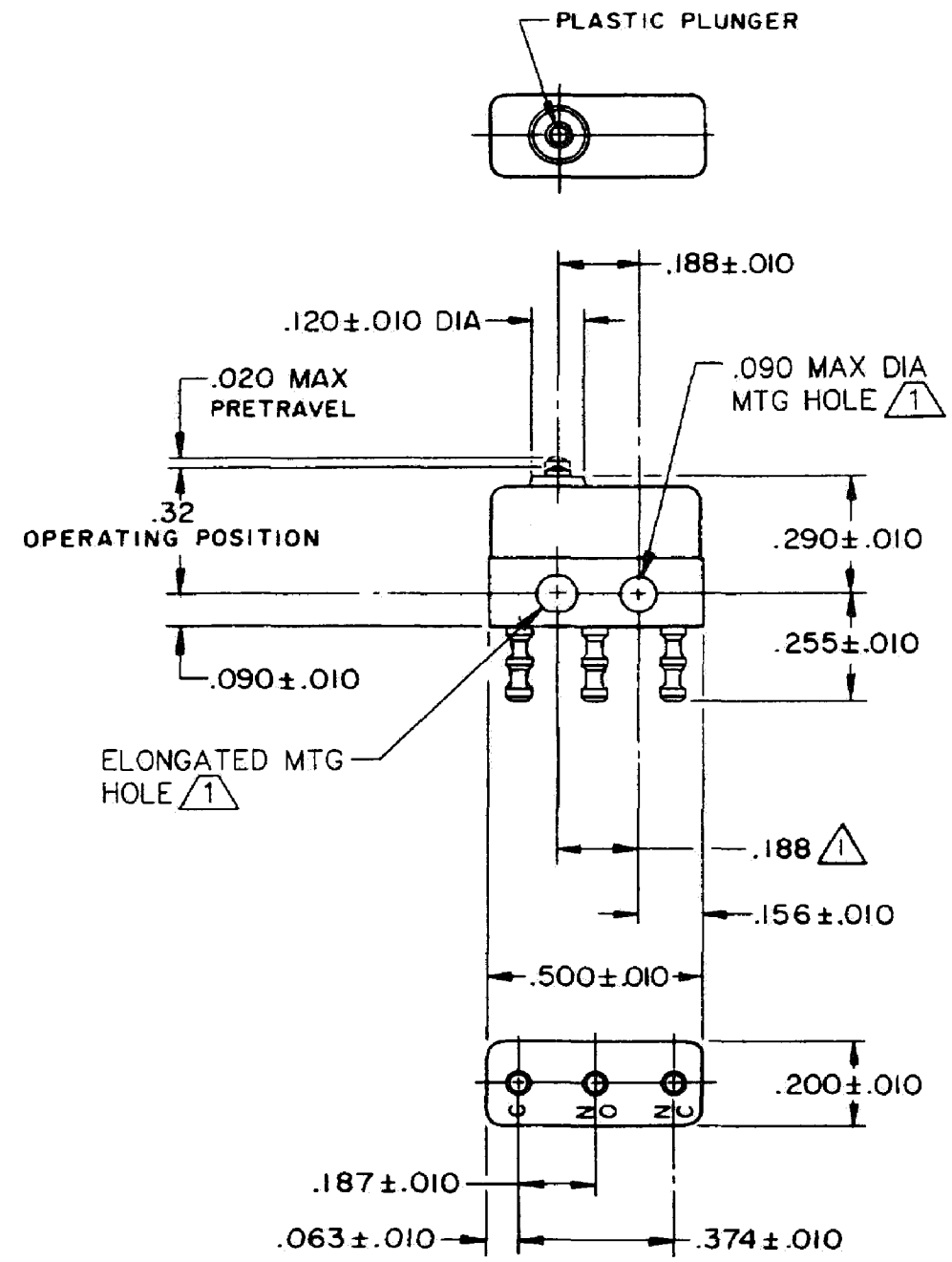

**NOTES**

- 1 MOUNTING HOLES WILL ACCEPT PINS OR SCREWS OF .087 MAX DIA ON .188±.002 CENTERS
- 2 - TERMINALS ARE PLATED FOR SOLDERING
- 3 - SWITCH WILL WITHSTAND TEMPERATURE OF 185° F

RELEASE NO.	PR-534
REPLACES	

CHARACTERISTICS	
OPERATING FORCE	5 OZ MAX
RELEASE FORCE	1 OZ MIN
DIFFERENTIAL TRAVEL	.005 MAX
OVERTRAVEL	.004 MIN

ELECTRICAL DATA			
CONTACT ARRANGEMENT SPDT			
	28 VOLTS DC RATING		115 VOLTS AC, 60 CPS
	SEA LEVEL	50,000 FT	SEA LEVEL
INDUCTIVE	4 AMP	2.5 AMP	7 AMP
RESISTIVE	7 AMP	4 AMP	7 AMP
LAMP	2.5 AMP	2.5 AMP	2 AMP
APPROVALS	KEMA, CE	7A 250 V ~ T125 5E4	UL, CSA
			7A 250 VAC

DESIGN UNITS: INCH
TOLERANCES UNLESS NOTED:
NO PLACE X ±
ONE PLACE .X ±
TWO PLACE .XX ±
THREE PLACE .XXX ±
FOUR PLACE .XXXX ±
ANGLES ±
THIRD ANGLE PROJECTION

DRAWN	SPK	20FEB08
CHECK	RJ	20FEB08
THIS DRAWING COVERS A PROPRIETARY ITEM AND IS THE PROPERTY OF HONEYWELL. THIS DRAWING IS NOT TO BE COPIED OR USED WITHOUT THE PERMISSION OF HONEYWELL.		
INTERPRET PER ANSI Y14.5M-1982 OTHER HONEYWELL ENGINEERING STANDARDS MAY APPLY		
RASTER		

<b>Honeywell</b>			
TITLE <b>SWITCH - BASIC</b>			
SIZE	TYPE	DRAWING NAME	REV
<b>B</b>	<b>I</b>	<b>21SX39-T2</b>	<b>12</b>
SCALE	-	WEIGHT: .003 LB MAX	SHEET 1 OF 1